

OPERATING INSTRUCTIONS AND PARTS MANUAL

MODEL C-90P

Coil Nailer

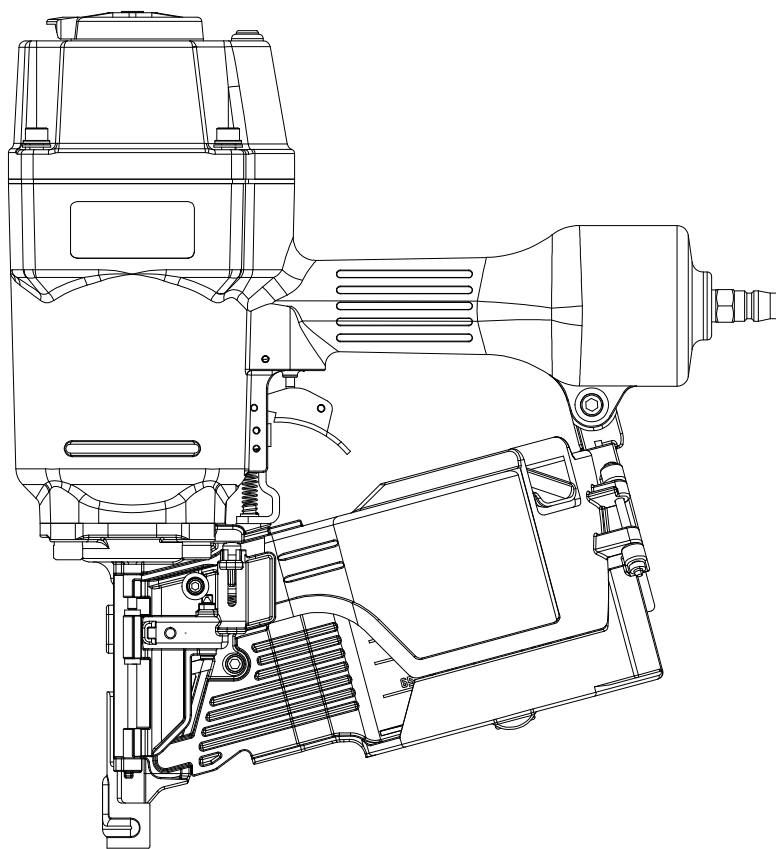

CAREFULLY READ THIS MANUAL BEFORE OPERATING TOOL

APLUS Pneumatic Corp.
NO.579, SEC. 1, SHEN LIN RD., TAYA, TAICHUNG CITY 428 TAIWAN, R.O.C.
Tel: 886-4-25602860 Fax: 886-4-25602859
Original instructions

OPERATING INSTRUCTIONS AND PARTS MANUAL

MODEL C-90P

Coil Nailer

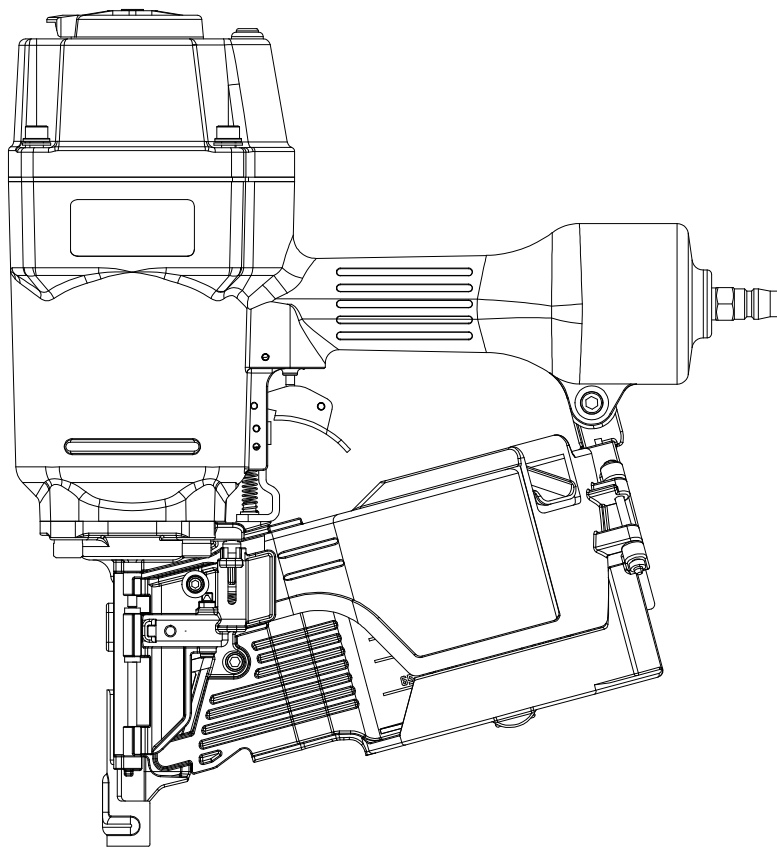

CAREFULLY READ THIS MANUAL BEFORE OPERATING TOOL

TOOL SPECIFICATIONS

MODEL OF TOOL	C-90P
TOOL LENGTH	13.39" (340 mm)
TOOL HEIGHT	14.76" (375 mm)
TOOL WIDTH	4.92" (125 mm)
WEIGHT (WITHOUT FASTENERS)	8.05 lbs (3.65 kg)
AIR INLET	1/4" NPT
COMPRESSED AIR :	
Maximum permissible operating pressure	115 PSIG (8 bar)
Recommended operating pressure range	75 ~ 110 PSIG (5 ~ 7.5 bar)
AIR CONSUMPTION.....	0.0773 scfm with 25 nails per minute @ 100 psi (6.9 bar)

Noise dB(A) :	
A-weighted sound pressure level LpA.....	87.21 dB(A)
A-weighted sound power level LwA.....	100.21 dB(A)
Measurement uncertainty: 3dB	
Vibration (m/s²) :	
Hand-arm vibration value.....	5.43 m/s ²
Measurement uncertainty: 1.5 m/s ²	

Warning:

The vibration emission during actual use of the power tool can differ from the declared total value depending on the ways in which the tool is used; and of the need to identify safety measures to protect the operator that are based on an estimation of exposure in the actual conditions of use (taking account of all parts of the operation cycle such as the times when the tool is switched off and when it is running idle in addition to the trigger time).

List of fasteners for C-90PA :

Shank Dia.	Head Dia.	MAGAZINE
φ 2.5 ~ φ 3.3 mm φ 0.10 ~ φ 0.13 "	φ 6.0 ~ φ 7.2 mm φ 0.24 ~ φ 0.28 "	150 ~ 300 pcs

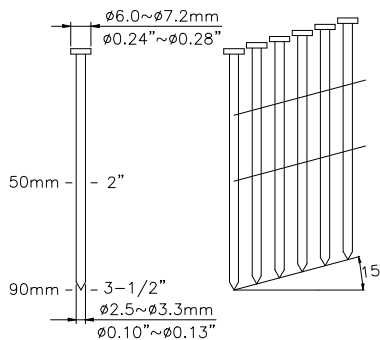

Foreword:

This pneumatic coil nailer is designed for blocking, pallet making and crate and box assembling. Its well balanced, ergonomic, comfort non-slip cushioned grip and heavy duty driving compatible staples to proper applications ensure you a satisfactory tackle and enjoy work. Fast speed improves work efficiency.

Suitable applications:

Blocking, pallet making, crate and box assembling.

Caution:

Coil nailers are only applying on wood. Not suitable for stapling or nailing into concrete, masonry bricks or steel. Do not fire if staples are jammed, as this will cause damage to the relevant parts.



DANGER

Indicates an imminently hazardous situation which, if not avoided, will result in death or serious injury.

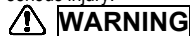

WARNING

Indicates a potentially hazardous situation which, if not avoided, will result in death or serious injury.

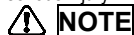

NOTE

Alerts the operator to useful information.

SAFETY INSTRUCTIONS



DANGER

1. Read this manual and understand all safety instructions before operation the tool. If you have any questions, please contact our authorized representatives.
2. Only those fasteners listed in the operating instructions may be used in the fastener driving tools.
3. Only the main energy and the lubricants listed in the operating instructions may be used.
4. Fastener driving tools marked with an inverted equilateral triangle standing on one point may only be used with an effective safety yoke.
5. Fastener driving tools equipped with contact actuation or continuous contact actuation, marked with the symbol " Do not use on scaffoldings, ladders", shall not be used for specific application for example:
 - when changing one driving location to another involves the use of scaffoldings, stairs, ladders, or ladder alike constructions, e.g. roof laths,
 - closing boxes or crates,
 - fitting transportation safety systems e.g. on vehicles and wagons.
6. For the maintenance of fastener driving tools, only spare parts specified by the manufacturer or his authorized representative shall be used.
7. Repairs shall carried out by agents authorized by the manufacturer or by other specialists, having due regard to the information given in the operating instruction.

8. Stands for mounting the fastener driving tools to a support for example a work table shall be designed and constructed by the stand manufacturer in such a way that the fastener driving tool can be safely fixed for the intended use, thus for example avoiding damage, distortion or displacement.
9. Fastener driving tools operated by compressed air shall only be connected to compressed air lines where the maximum allowable pressure cannot be exceed by a factor of more than 10%, which can for example be achieved by a pressure reduction valve which includes a downstream safety valve.
10. When using fastener driving tools operated by compressed air, particular attention must be paid to avoid exceeding the maximum allowable pressure.
11. When using fastener driving tools operated by compressed air should only be operated at the lowest pressure required for the work process at hand, in order to prevent unnecessarily high noise levels, increased wear and resulting failures.
12. Hazards caused by fire and explosion when using oxygen or combustible gases for operating compressed air operated fastener driving tools.
13. Carry the fastener driving tool at workpiece using only the handgrip, and never with the trigger actuated. Never carry the tool by the hose or pull the hose to move the tool.

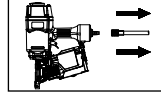

14. Disconnect the tool from air supply before cleaning jams, servicing, adjusting, and during non-operation.



15. Wear eye protection.

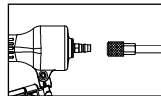

16. Do not use a check valve or any other fitting which allows air to remain in the tool.



17. Do not place your hand or any part of your body in the fastener discharge area of the tool when connecting or disconnecting air supply.



18. Never point tool at yourself or at any other person.



19. Do not use on scaffoldings, ladders.

AIR SUPPLY AND CONNECTION



NOTE

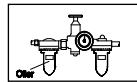

- Many air tool users find it convenient to use oiler to help provide oil circulation through tool and increase the efficiency and useful life of the tool. Check oil level in the oiler daily.

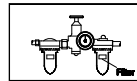

- Many air tool user find it convenient to use a filter to remove liquid and impurities which can rust or wear internal parts of the tool. A filter also increase the efficiency and useful of the tool. The filter must be checked on a daily basis and if necessary drained.

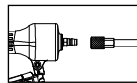

- For better performance, install a 3/8" quick connector (1/4" NPT threads) with an inside diameter of .315" on your tool and a 3/8" quick coupler on the air hose.

The following illustration shows the correct mode of connection to the air supply system which will increase the efficiency and useful life of the tool.

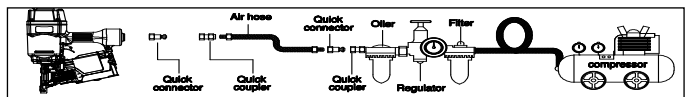

LUBRICATION AND MAINTENANCE



NOTE

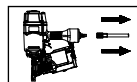

- Disconnect the air supply from the tool before lubricating.



- Your tool requires lubrication before you use it for the first time.

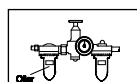

- Wipe off excessive oil at the exhaust. Excessive oil will damage O-rings of tool. If in-line oiler is used, manual lubrication through the air inlet is not required on a daily basis.



- Turn the tool so the inlet is facing up and put one drop of high speed spindle oil, UNOCAL RX22, or 3-IN-1 oil into air inlet. Never use detergent oil or additives. Operate the tool briefly after adding oil.

LOADING THE TOOL

WARNING

- Do not place your hand or any part of your body in the fastener discharge area of the tool when connecting or disconnecting air supply.

WARNING

- Never point any operational fastener driving tool at yourself or at any other person.

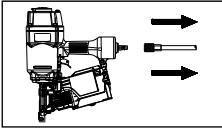

1. Disconnect air hose.

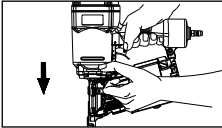

2. Press down on the feeder door latch and lift open feed door. Fold back magazine cover.

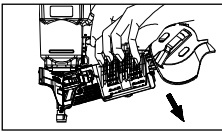

3. Place the nail coil in the magazine. Make sure nail tip face down and nails have no damages.

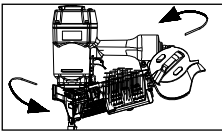

4. Close canister cover. And then close door. Make sure door latch is fully latched.

OPERATING THE TOOL

WARNING

Protect your eyes and ears. Wear z87.1 safety glasses with side shields. Wear hearing protection. Employers and users are responsible for ensuring the user or anyone near the tool wear this safety protection.



NOTE

Check and replace any damaged or worn components on the tool. The safety warning labels on the tool must also be replaced if they are not legible.



Fig.1

1. Add a few drops of UNOCAL RX22 or 3-in-1 oil into the air inlet. (See Fig. 1)

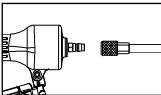

Fig.2

2. Attach a high flow quick connect fitting to the tool. (See Fig. 2)

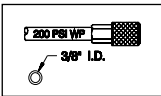

Fig.3

3. Empty the magazine.

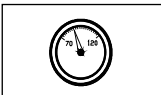

Fig.4

4. Connect the tool to an air compressor using a 3/8" I.D hose. Make sure the hose has a rated working pressure exceeding 200 PSI (13.8bar) and a female quick coupler. (See Fig. 3)

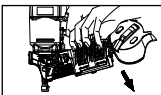

Fig.5

5. Regulate the air pressure to obtain 70 PSI (4.8 bar) at the tool. (See Fig. 4)

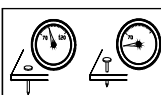

Fig.6

6. Disconnect the air supply from the tool.

7. Load fasteners into your tool following the instructions in this manual. (See Fig. 5)

8. Reconnect the air supply to the tool.

9. Test for proper fastener penetration by driving nails into a sample piece of wood. If the fasteners do not achieve the desired penetration, adjust the air pressure to a higher setting until the desired penetration is achieved. Do not exceed 110 PSI (7.6 bar) at the tool. (See Fig. 6)

CONTACT SAFETY TRIP MECHANISM

OPERATING A CONTACT SAFETY TRIP TOOL :

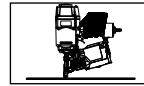

- The operator requires finger to be off the trigger and the nose of the tool to be placed on the workpiece.

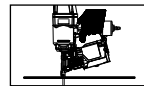

- The contact safety trip mechanism is then depressed against the workpiece and the trigger is pulled to drive a fastener.

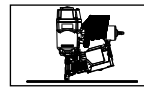

- The trigger is released after each fastener is driven.

- Move the tool to next location and the above procedure repeated.

CHECKING OPERATION OF CONTACT SAFETY TRIP MECHANISM:

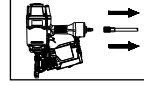

- Disconnect the air supply from the tool.



- Empty the magazine.

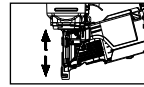

- Make sure the trigger and contact safety trip mechanism move up and down without any sticking.

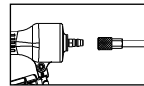

- Connect air supply to the tool.



- Depress the contact safety trip mechanism against the workpiece without pulling the trigger. The tool must not cycle. Never use the tool if a cycle occurs.

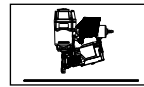

- Hold the tool clear of the workpiece. The contact safety trip mechanism should return to its original down position. Pull the trigger. The tool must not cycle. Never use the tool if a cycle occurs.

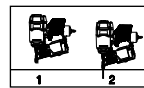

- Depress the contact safety mechanism again the workpiece and pull the trigger, the tool must cycle.

CLEARING A JAM FROM THE TOOL

WARNING

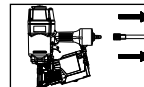

Disconnect the tool from air compressor before adjusting, clearing jams, servicing, relocating and during non-operation.

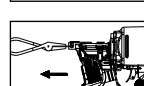

1. Fastener jammed in fastener discharge area:

- Disconnect tool from air hose.
- Grab jammed fastener with pliers and remove.



2. Fastener jam inside magazine:

- Disconnect air tool from air hose.
- Pull back on fastener pusher until locked.
- Removed jammed fastener.
- Release fastener pusher.

CLEANING THE TOOL

DANGER



Never use gasoline or other flammable liquids to clean the tool. Vapors in the tool will ignite by a spark and cause the tool to explode and result in death or serious personal injury.

NOTE



Solvents used to clean the nose of the tool and contact safety trip mechanism may soften the tar on the shingles and cause the buildup to be accelerated. Make sure to dry the tool thoroughly after cleaning and before operating the tool again.



1. Disconnect the air supply from the tool.

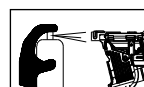

2. Remove tar buildup with kerosene #2 fuel oil or diesel fuel. Do not allow solvent to get into the cylinder or damage may occur. Dry off the tool completely before use.

C90PAFSB16 (CG/S1-16)

a

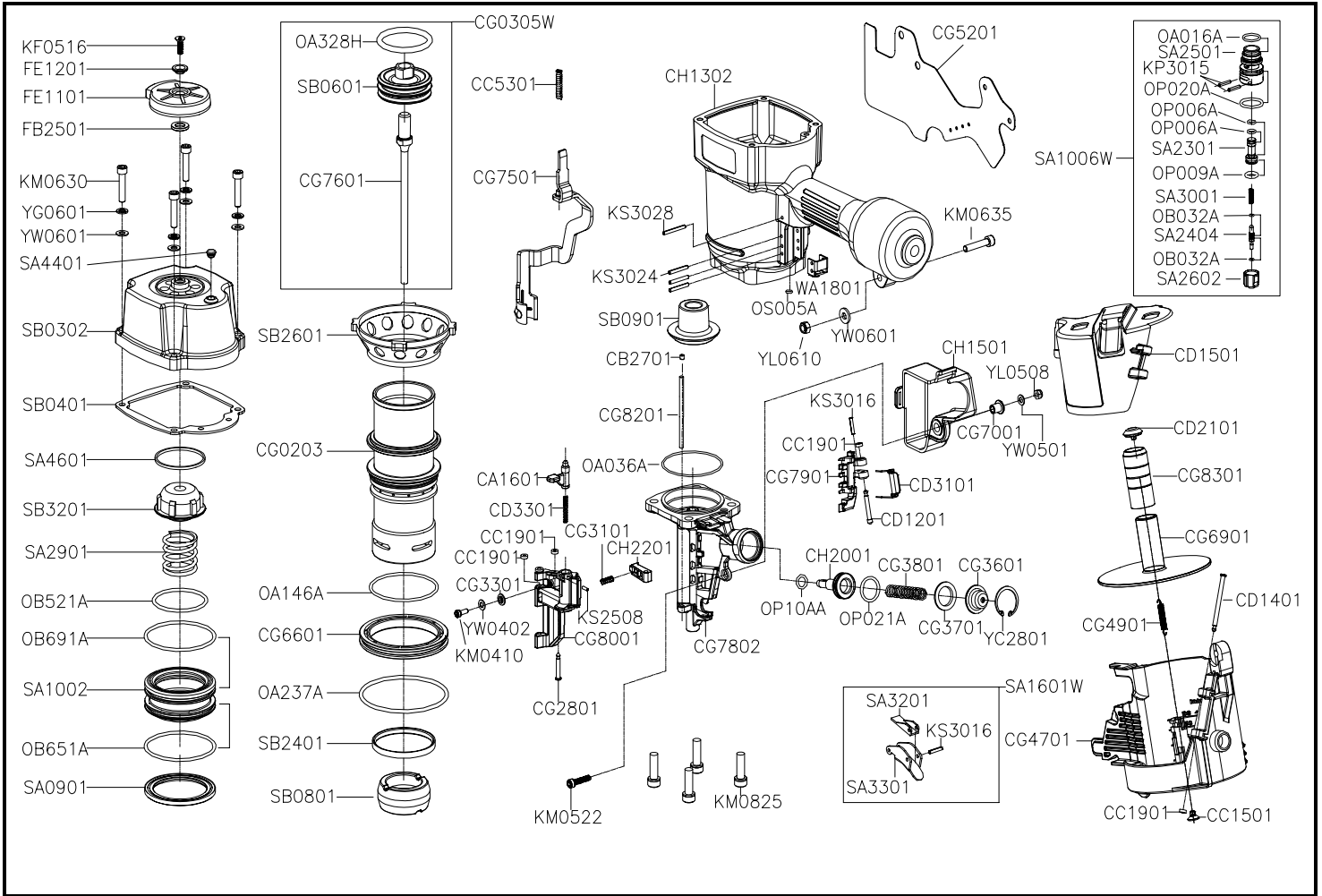

Part_No	Description	Spec	Q'ty	Part_No	Description	Spec	Q'ty	Part_No	Description	Spec	Q'ty
CA1601	DOOR LATCH		1	CH2001	FEED PISTON CAP		1	SA1601W	TRIGGER ASSY.		1
CB2701	PIN CAP		1	CH2201	HOLDING PAWL		1	SA2301	PILOT VALVE		1
CC1501	SPRING RECEIVER		1	FB2501	PISTON STOP		1	SA2404	TRIGGER VALVE STEM		1
CC1901	BUSHING		4	FE1101	EXHAUST CAP		1	SA2501	TRIGGER VALVE SEAT		1
CC5301	COMPRESSION SPRING		1	FE1201	EXHAUST CAP RING		1	SA2602	TRIGGER VALVE SEAT		1
CD1201	PIN		1	KF0516	FLAT HD.BOLT	M5×0.8-16L	1	SA2901	COMPRESSION SPRING		1
CD1401	PIN		1	KM0410	HEX.SOC.HD.BOLT	M4×0.7-10L	1	SA3001	COMPRESSION SPRING		1
CD1501	CANISTER COVER		1	KM0522	HEX.SOC.HD.BOLT	M5×0.8-22L	1	SA3201	CONTACT LEVER		1
CD2101	SPRING RECEIVER		1	KM0630	HEX.SOC.HD.BOLT	M6×1.0-30L	4	SA3301	TRIGGER		1
CD3101	SPRING		1	KM0635	HEX.SOC.HD.BOLT	M6×1.0-35L	1	SA4401	GROMMET		1
CD3301	COMPRESSION SPRING		1	KM0825	HEX.SOC.HD.BOLT	M8×1.25-25L	4	SA4601	SPACER		1
CG0203	CYLINDER		1	KP3015	PARALLEL PIN	∅ 3×15L	2	SB0302	CYLINDER CAP		1
CG0305W	DRIVER ASSY.		1	KS2508	SPRING PIN	∅ 2.5-8L	1	SB0401	CAP SEAL		1
CG2801	PIN		1	KS3016	SPRING PIN	∅ 3-16L	2	SB0601	MAIN PISTON		1
CG3101	COMPRESSION SPRING		1	KS3024	SPRING PIN	∅ 3-24L	3	SB0801	TOP BUMPER		1
CG3301	SCREW RING		1	KS3028	SPRING PIN	∅ 3-28L	1	SB0901	BOTTOM BUMPER		1
CG3601	FEED PISTON CAP		1	OA016A	O-RING	ARP568-016	1	SB2401	CHECK SEAL		1
CG3701	PISTON BUMPER		1	OA036A	O-RING	ARP568-036	1	SB2601	COLLAR		1
CG3801	COMPRESSION SPRING		1	OA146A	O-RING	ARP568-146	1	SB3201	PISTON STOP		1
CG4701	CANISTER		1	OA237A	O-RING	ARP568-237	1	WA1801	SAFETY GUIDE		1
CG4901	PULL SPRING		1	OA328H	O-RING	46.99×5.33	1	YC2801	C-RING	∅ 28	1
CG5201	DUST SHIELD		1	OB032A	O-RING	2.5×1.4	2	YG0601	SPRING WASHER	∅ 6	4
CG6601	CYLINDER RING		1	OB521A	O-RING	51.5×3.1	1	YL0508	LOCK NUT	M5×0.8	1
CG6901	FIXED SEAT		1	OB651A	O-RING	65×3	1	YL0610	LOCK NUT	M6×1.0	1
CG7001	BUSHING		1	OB691A	O-RING	68.5×2.95	1	YW0402	FLAT WASHER	∅ 4	1
CG7501	SAFETY		1	OP006A	O-RING	P6	2	YW0501	FLAT WASHER	∅ 5	1
CG7601	DRIVER		1	OP009A	O-RING	P9	1	YW0601	FLAT WASHER	∅ 6	5
CG7802	NOSE		1	OP020A	O-RING	P20	1				
CG7901	FEED PAWL		1	OP021A	O-RING	P21	1				
CG8001	DOOR		1	OP10AA	O-RING	P10A	1				
CG8201	PIN		1	OS005A	O-RING	S-5	1				
CG8301	BUSHING		1	SA0901	HEAD VALVE SEAL		1				
CH1302	BODY		1	SA1002	HEAD VALVE PISTON		1				
CH1501	TRIP COVER		1	SA1006W	RESTRICTIVE TRIGGER ASSY		1				

★☆☆ If you need to order parts, please mark both Parts No. and Description.★☆☆